

# 95030, 95040, 95050, 95060 SERIES

## Straight Line Action Clamps | Product Overview

### Features:

- Low profile with high holding capacities
- Cast steel base and handle
- Allow handle to rotate and fall below mounting plane to lock in retracted position

### Applications:

- Assembly
- Testing
- Tensioning devices

### Also Available:

See page MC-ACC-1 for accessories

95030

95040

95050 ⓘ

95060 ⓘ



## Technical Information | Holding Capacities

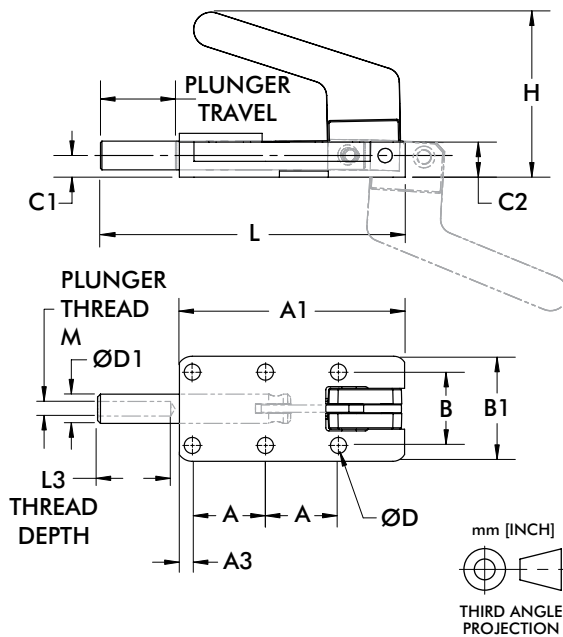

Model	Max. Holding Capacity	Weight	Plunger Travel	(M) Plunger Thread	Recommended Spindle (Not Supplied)
95030	[550 lbf] 2450 N	[0.80lb] 2,58kg	[0.98] 24,9	M6	205203-M
95040	[1100 lbf] 4900 N	[1.60lb] 0,73kg	[1.50] 38,1	M8	207203-M
95050 ⓘ	[1650 lbf] 7340 N	[2.10lb] 0,95kg	[1.97] 50	M12	220203-M
95060 ⓘ	[3960 lbf] 17600 N	[6.4lb] 2,9kg	[2.36] 60		

ⓘ This item is available upon request

HC = Holding Capacity, EF = Exerting Force, AF = Applied Force

Part No.	A	A1	A3	B	B1	C1	C2	ØD	ØD1	H	L	L3*
95030	25 [0.98]	77 [3.03]	4.4 [0.17]	25 [0.98]	35.9 [1.41]	7.5 [0.30]	12.2 [0.48]	5.5 [0.22]	10 [0.39]	56 [2.20]	105 [4.13]	25 [0.98]
95040	35 [1.38]	109 [4.29]	7.9 [0.31]	35 [1.38]	50.7 [2.00]	10 [0.39]	18.3 [0.72]	6.5 [0.26]	14 [0.55]	77 [3.03]	149.1 [5.87]	35 [1.38]
95050 ⓘ	45 [1.77]	138.5 [5.45]	8.7 [0.34]	45 [1.77]	66 [2.60]	14 [0.55]	23.8 [0.94]	8.5 [0.33]	19 [0.75]	78 [3.07]	189.8 [7.47]	55 [2.17]
95060 ⓘ	55 [2.17]	167 [6.57]	10.2 [0.40]	55 [2.17]	77 [3.03]	16 [0.63]	27.4 [1.08]	10.5 [0.41]	22 [0.87]	92 [3.62]	229 [9.02]	65 [2.56]

ⓘ This item is available upon request

\*Minimum